

THE LEICESTERSHIRE COUNTY COUNCIL
(VARIOUS ROADS, LOUGHBOROUGH (AREA 5), DISTRICT OF CHARNWOOD)
AMENDMENT ORDER NO. 2 2011

The Leicestershire County Council ("the Council") in exercise of its powers under Section 1(1) and 2(1) to (3) 4(2) 32 35 and Part IV of Schedule 9 of the Road Traffic Regulation Act 1984 ("the Act") and of all other enabling powers, hereby makes the following Order:-

1. This Order shall come into force on the Twenty-Fifth day of July 2011 and may be cited as "The Leicestershire County Council (Various Roads, Loughborough (Area 5), District of Charnwood) Amendment Order No. 2 2011".
2. The exemptions contained in this Order as set out in column 1 of Schedule 1 shall hereafter be referred to by reference to the code letters given in column 2 of Schedule 1.
3. (1) In this Order –

"authorised cab rank" means any area of carriageway which is comprised within and indicated by a road marking complying with diagram 1028.2 in Schedule 6 of The Traffic Signs Regulations and General Directions 2002;

"authorised parking place" means any parking place on a road authorised or designated by an Order made or having effect as if made under the Act;

"bus" means any Public Service Vehicle or bus operating a local stage carriage service as defined in the Transport Act 1985;

"bus stop area" means any area of carriageway on the sides of roads specified in this Order which is comprised within and indicated by a road marking complying with either diagram 1025.2 or diagram 1025.3 to the Traffic Signs Regulations and General Directions 2002;

"C.E.O." means a duly authorised Civil Enforcement Officer;

"disabled person's badge" has the same meaning as in The Disabled Persons (Badges for Motor Vehicles)(Amendment) Regulations 1991; or the Disabled Persons (Badges for Motor Vehicles)(England) Regulations 2000 and the Local Authorities' Traffic Orders (Exemptions for Disabled Persons)(England) Regulations 2000;

"disabled person's vehicle" has the same meaning as in The Local Authorities' Traffic Orders (Exemption for Disabled Persons)(England and Wales)(Amendment) Regulations 1991;

"disabled persons designated parking bay" means the part of the carriageway or side of road marked in accordance with Schedule 6 of the Traffic Signs Regulations and General Directions 2002 by the marking shown in diagram 1028.3 (or permitted variant thereof) and with a white broken line bounding the words "DISABLED" marked outside the bay;

"doctors' permit holders" means a vehicle which displays a valid permit issued to a Doctor for use in a specified location;

"footway parking area" means an area of the footway specifically designated for the purpose of waiting;

"hackney carriage" has the same meaning as in section 38(1) of the Vehicles (Excise) Act 1971;

"Loading" and "Unloading" means the collection or delivery of goods (parcels, stock and other items of that nature) to or from a vehicle where the goods cannot be reasonably collected or delivered except by the use of that vehicle in a particular length of road.

"market day" means any day of the week approved and authorised under a market charter for the holding of a market or such other bona fide licensed market;

"Market trader" means any person duly authorised an appropriate body to trade from an authorised market stall or stand or location as from time to time may be specified by the appropriate body for the purposes of his or her trading;

"motor vehicle" means any vehicle as defined by the Construction and Use Regulations 1986 (as amended) which is mechanically propelled except where otherwise provided;

"parking disc" means a disc, issued by a local authority, complying with the requirements of the British Standard Specification for Parking Discs (BS No.4631:1970) but coloured orange, and capable of showing the quarter hour period during which a period of waiting begins, or a blue badge under the Disabled Persons (Badges for Motor Vehicles)(England) Regulations 2000;

"permitted parking place" means any part of a road hereby authorised by the Council for use as a parking place being a place where vehicles may wait and is indicated as such by signs and road markings;

"permit" means a written warrant issued by or on behalf of Leicestershire County Council allowing the holder to wait in a specified location;

"permit holder" means a vehicle which displays a valid permit;

"residents' parking permit holder / residents' permit holder" means a vehicle which displays a valid permit issued to a resident of the specified location;

"road / roads" means the carriageway the footway and any verges being the full width of the highway extent from one boundary to another;

"school entrance" means any area of carriageway on the side of the road specified in Schedule 12 of this Order where vehicles are not permitted to stop and indicated by a road marking complying with diagram 1027.1 of the 2002 Regulations;

"vehicle" means any Motor Vehicle as defined in this Order and any other vehicle (capable of the carriage of persons or goods) except cycles unless otherwise provided;

"4.00 p.m. to 10.00 a.m. the following morning" wherever referred to in this Order means that period of time commencing at 4.00 p.m. in the afternoon of any day and terminating at 10.00 a.m. on the morning of the next day;

"The Act" means The Road Traffic Regulation Act 1984.

(2) For the purpose of this Order a vehicle shall be regarded as displaying a disabled person's badge in the relevant position, where in accordance with the Disabled Persons (Badges for Motor Vehicles) (Amendment) Regulations 1991 and the Disabled Persons (Badges for Motor Vehicles) (England) Regulations 2000

(i) the Badge is displayed on the vehicle's dashboard or fascia panel with the front of the Badge facing forward with the details thereon clearly visible from an external position, or

(ii) where the vehicle has no dashboard or fascia panel or windscreen where the Badge may be exhibited or displayed it shall be exhibited in a conspicuous position on the front or near side of the vehicle and

in either case a parking disc is exhibited in the relevant position prescribed in the Disabled Persons (Badges for Motor Vehicles) (Amendment) Regulations 1991 or the Disabled Persons (Badges for Motor Vehicles) (England) Regulations 2000.

(3) For the purposes of this Order and where any article permits, it shall not be unlawful to cause or permit a disabled person's vehicle which displays in the relevant position a disabled person's badge and a parking disc (on which the driver, or other person in charge of the vehicle, has marked the time at which the period of waiting began) to wait on the sides of roads referred to in the specific article, for a period not exceeding 3 hours unless otherwise stated (not being a period separated by an interval of less than one hour, unless otherwise stated, from a previous period of waiting by the same vehicle on the same side of road on the same day) provided that no such vehicle shall wait in any length of road where there is for the time being a prohibition of loading and unloading.

4. "The Leicestershire County Council (Various Roads, Loughborough (Area 5), District of Charnwood) Amendment Order No. 1 2010" is hereby revoked in respect of those lengths of roads as specified in Schedule 2 to this Order.

- 5.1 No person shall, except upon the direction or with the permission of a police officer in uniform, a community support officer, a parking attendant or a C.E.O., or in accordance with the exemption provisions, cause or permit any vehicle to wait at any time on any day, on the sides of road specified in Schedule 3 to this Order.
- 6.1 The written restriction applicable to those lengths of roads referred to in Schedule 4 are hereby revoked and re-enacted as amended in Schedule 5. Such amendments shall have no practical effect on the restrictions as set out on those lengths of roads and shall not affect the use of such roads by members of the public.
- 6.2 No person shall, except upon the direction or with the permission of a police officer in uniform, a community support officer, a parking attendant or a C.E.O., cause or permit any vehicle to wait between the hours of 9.00 a.m. and 4.30 p.m. on any day other than a Sunday, in the permitted parking place specified in Schedule 5 Part 1 to this Order:-
- (a) For a period longer than 30 minutes, or
 - (b) If a period of less than 30 minutes has elapsed since the last period of waiting by that vehicle on the same permitted parking place;
- 6.3 No person shall, except upon the direction or with the permission of a police officer in uniform, a community support officer, a parking attendant or a C.E.O., or in accordance with the exemption provisions, cause or permit any vehicle to wait between the hours of 7.30 a.m. and 9.00 a.m. and 4.30 p.m. and 6.00 p.m. on any day other than a Sunday, for the purpose of enabling goods to be loaded or unloaded from the vehicle on the sides of road specified in Schedule 5 Part 2 to this Order.
- 6.4 No person shall, except upon the direction or with the permission of a police officer in uniform, a community support officer, a parking attendant or a C.E.O., or in accordance with the exemption provisions, cause or permit any vehicle to wait at any time on any day, on the sides of road specified in Schedule 5 Part 3 to this Order.
- 6.5 No person shall, except upon the direction or with the permission of a police officer in uniform, a community support officer, a parking attendant or a C.E.O., or in accordance with the exemption provisions, cause or permit any vehicle to wait between the hours of 7.30 a.m. and

9.00 a.m. and 4.30 p.m. and 6.00 p.m. on any day other than a Sunday on the sides of road specified in Schedule 5 Part 4 to this Order.

7. Except where otherwise stated, a reference in this Order to a numbered Article or Schedule is reference to the Article or Schedule bearing that number in this Order.
8. The plans annexed to this Order and marked drawing numbers TM3715/1/2010 and TM2904/1/2010 are for identification purposes only.

SCHEDULE 1

TYPE OF EXEMPTION	CODE
For vehicles to allow people to board or alight.	LCCA
For vehicles used in connection with:- (i) building, industrial or demolition operations; (ii) the removal of any obstruction to traffic; (iii) the maintenance, improvement or reconstruction of the said sides of roads; or (iv) the laying, erection, alternative or repair on, or in land adjacent to the said sides of roads of any sewer or of any main, pipe or apparatus for the supply of gas, water or electricity or of any telegraphic line as defined in the Telecommunications Act 1984.	LCCB
For vehicles to be used in the service of a local authority, highways agency, an area health authority or a water undertaker in pursuance of statutory powers or duties and whilst being so used in such service it is necessary for the vehicle to be positioned in the place where it is waiting.	LCCC
For vehicles to be used for the purpose of delivering or collecting postal packets as defined in section 87 of the Postal Services Act 2000 by any universal service provider.	LCCD
For vehicle to take in petrol, oil water or air from any garages situated on or adjacent to the said sides of roads	LCCE
For vehicles to wait at or near to any premises situated on or adjacent to the said sides of roads for so long as such waiting by that vehicle is reasonably necessary in connection with any wedding or funeral.	LCCF
For vehicles to be used for fire brigade, ambulance or police purposes.	LCCG
For goods to be loaded on or unloaded from the vehicle on the sides of roads specified in this Order.	LCCH
For Vehicles: (a) to wait upon an authorised parking place, (b) being a hackney carriage, to wait upon an authorised cab rank, or	LCCI

(c) licensed taxi.	
For a disabled person's vehicle which displays in the relevant position a disabled person's badge, and a parking disc (on which the driver, or other person in charge of the vehicle, has marked the time at which the period of waiting began) to wait on the sides of roads referred to in that Schedule for a period not exceeding three hours (not being a period separated by an interval of less than one hour from a previous period of waiting by the same vehicle on the same side of road on the same day) provided that no such vehicle shall wait in any length of road where there is for the time being a prohibition of loading and unloading.	LCCJ
For vehicles to wait on the sides of roads referred to therein for so long as may be necessary while any gate or other barrier at the entrance to premises to which the vehicle requires access or from which it has just emerged is being opened or closed, if it is not reasonably practicable for the vehicle to wait otherwise than in that road while such a gate or barrier is opened or closed.	LCCK
Any vehicle bona fide associated or used in connection with or for the purpose of licensed markets or special events.	LCCL
Where the person in control of the vehicle is directed or given permission to stop by a police officer, community support officer or a civil enforcement officer.	LCCM
To enable any motor vehicle that is constructed or adapted for the purpose of carrying monies or valuables under secure deposit and which is in use on a pre-arranged appointment for the delivery or collection of monies, financial instruments or valuables (for such a period of time as reasonably required to complete the delivery or collection) to any premises on the sides of road.	LCCN
The Article shall not prevent waiting by vehicles carrying children from and to school on normal school days	LCCO
Nothing shall render it unlawful for the owners or occupiers for the time being of the three properties No's 2, 4 and 6 Baines Lane, Hinckley to cause or permit any vehicle to wait in the length of road or side road specified	LCCP

in the Third Schedule to this Order for a period not exceeding 1 hour between the hours of 8.30am and 6.00pm (Monday to Saturday inclusive) and without limitation on Sundays.	
Nothing shall render it unlawful to cause or permit any vehicle to wait in connection with the maintenance or repair of any premises adjoining the roads which can only be carried out from the road being such works as are required to be carried out to comply with any statutory obligation condition or stipulation subject to such waiting being limited to a maximum of two hours in any period of 24 hours.	LCCQ
Nothing shall render it unlawful to cause or permit a public service vehicle to stop for a longer time than is necessary for taking up and setting down passengers at any time on any day on the east side of Melbourne Road fronting the coach depot occupying 211/213 Melbourne Road	LCCR
For any disabled person's vehicle which displays in the relevant position a disabled person's badge and a parking badge (on which the driver or other person in charge of the vehicle has marked the time at which waiting began) to wait, load or unload in those parts of the road specified in the schedule to this order for a period not exceeding 3 hours, with no return within 3 hours.	LCCS
If the vehicle is being used to attend any of the properties numbered 2-30 Mantle Lane, but for the purposes of loading/unloading of goods or equipment at such property only	LCCT
If the vehicle is an official wedding or funeral car attending any of the properties numbered 2 -30 Mantle Lane for the purpose of allowing passengers to board or alight.	LCCU
For any vehicle in excess of 7.5 tonnes loading or unloading on that part of Biggin Street between its junction with Fennel Street and a point 35 metres north of its junction with Swan Street, such vehicle shall have entered Biggin Street from its junction with Fennel Street between the hours of 4.00p.m. to midnight and midnight to 10.00 a.m.	LCCV
Nothing shall render it unlawful to cause or permit any vehicle to wait on the triangular area or highway not comprising part of the main carriageway fronting Nos 9 and 19 Station Road, Hugglescote	LCCW
Nothing shall render it unlawful to cause any vehicle to	LCCX

<p>enter Market Place if the vehicle is a vehicle-</p> <p>(a) in the service of a Police or Fire or Health or Local Authority and is being used for Police, Fire, Ambulance or Local Authority purposes as the case may be;</p> <p>being used by a resident of Market Place for the purpose of gaining access to his place of residence there.</p>	
<p>For a disabled person's vehicle which displays in the relevant position a disabled person's badge and a parking disc (on which the driver, or other person in charge of the vehicle, has marked the time at which the period of waiting began) to wait in the designated parking place.</p>	LCCY

SCHEDULE 2
REVOCATIONS

THE LEICESTERSHIRE COUNTY COUNCIL
(VARIOUS ROADS, LOUGHBOROUGH (AREA 5),
DISTRICT OF CHARNWOOD) AMENDMENT ORDER NO.1 2010

NO WAITING AT ANY TIME

EMPRESS ROAD, LOUGHBOROUGH

The south side from a point 45 metres east of the centre line over the Railway Line, in a westerly direction for a distance of 83 metres.

SCHEDULE 3

NO WAITING AT ANY TIME

EMPRESS ROAD, LOUGHBOROUGH

Both sides from a point 45 metres east of the centre line over the Railway Line, in a westerly direction for a distance of 83 metres.

TATMARSH, LOUGHBOROUGH

Both sides from its junction with Bridge Street in a north-westerly direction for a distance of approximately 69 metres.

EXEMPTIONS

The following exemptions apply to the above. Refer to Schedule 1 for the details of each exemption:-

LCCA, LCCB, LCCC, LCCD, LCCE, LCCF, LCCG, LCCH, LCCI, LCCJ, LCCM, LCCN.

SCHEDULE 4
ANOMALY REVOCATIONS

THE LEICESTERSHIRE COUNTY COUNCIL
(VARIOUS ROADS, LOUGHBOROUGH (AREA 5), DISTRICT OF CHARNWOOD),
CONSOLIDATION AND AMENDMENT ORDER 2009

LIMITED WAITING 30 MINUTES NO RETURN FOR 30 MINUTES
MONDAY – SATURDAY 9.00 AM - 4.30 PM

LEICESTER ROAD, LOUGHBOROUGH

- (i) The east side between points 42 metres and 2 metres north of its junction with Gregory Street
- (ii) The east side from a point 2 metres south of its junction with Gregory Street to a point 10 metres north of its junction with Factory Street
- (iii) The east side between points 68 metres and 55 metres north of its junction with Gregory Street
- (iv) The east side from the boundary between properties No. 24 & 26 Leicester Road to a point 78 metres north of its junction with Gregory Street

NO LOADING
MONDAY - SATURDAY 7.30 AM - 9.00 AM AND 4.30 PM – 6.00 PM

LEICESTER ROAD, LOUGHBOROUGH

- (i) The east side from a point 5 metres south of its junction with Gregory Street to a point 14 metres north of its junction with Factory Street
- (ii) The east side from a point 5.5 metres north of its junction with Gregory Street to a point 5 metres south of that junction.
- (iii) The east side between points 45.5 metres and 5.5 metres north of its junction with Gregory Street.
- (iv) The east side between points 72 metres and 59 metres north of its junction with Gregory Street.
- (v) The east side between 59 metres and 45.5 metres north of its junction with Gregory Street.
- (vi) The east side from the boundary between properties No. 24 & 26 Leicester Road to a point 82 metres north of its junction with Gregory Street.
- (vii) The east side between points 82 metres and 72 metres north of its junction with Gregory Street.

LEICESTER ROAD / DERBY ROAD, LOUGHBOROUGH

The east side from its junction with Belton Road/Alan Moss Road to the boundary between properties No.24 & 26 Leicester Road.

NO WAITING AT ANY TIME

LEICESTER ROAD, LOUGHBOROUGH

- (i) The east side between points 59 metres and 45.5 metres north of its junction with Gregory Street.
- (ii) The east side from a point 2 metres north of its junction with Gregory Street to a point 2 metres south of that junction.

LEICESTER ROAD / DERBY ROAD, LOUGHBOROUGH

The east side from its junction with Belton Road/Alan Moss Road to the boundary between properties No.24 & 26 Leicester Road.

**NO WAITING
MONDAY - SATURDAY**

BROMHEAD STREET, LOUGHBOROUGH

The south-west side from its junction with Nottingham Road in an easterly direction to its junction with Bishop Street.

**NO WAITING
MONDAY - SATURDAY 7.30 AM - 9.30 AM AND 4.30 PM – 6.00 PM**

LEICESTER ROAD, LOUGHBOROUGH

The east side between points 72 metres and 59 metres north of its junction with Gregory Street.

NO WAITING
MONDAY - SATURDAY 7.30 AM – 9.00 AM AND 4.30 PM – 6.00 PM

LEICESTER ROAD, LOUGHBOROUGH

- (i) The east side from a point 5 metres south of its junction with Gregory Street to a point 14 metres north of its junction with Factory Street.
- (ii) The east side between points 45.5 metres and 5.5 metres north of its junction with Gregory Street.
- (iii) The east side from the boundary between properties No. 24 & 26 Leicester Road to a point 82 metres north of its junction with Gregory Street.

SCHEDULE 5
ANOMALIES

SCHEDULE 5 PART 1

LIMITED WAITING
30 MINS NO RETURN FOR 30 MINUTES
MONDAY - SATURDAY 9.00 AM - 4.30 PM

LEICESTER ROAD, LOUGHBOROUGH

- (i) The north-east side from a point 55 metres north-west of its junction with Gregory Street in a north-westerly direction for a distance of 13 metres.
- (ii) The north-east side from a point 78 metres north-west of its junction with Gregory Street in a north-westerly direction to the boundary of Nos. 24/26 Leicester Road.
- (iii) The north-east side from a point 2 metres north-west of its junction with Gregory Street in a north-westerly direction for a distance of 40 metres.
- (iv) The north-east side from a point 10 metres north-west of its junction with Factory Street in a north-westerly direction to a point 2 metres south-east of its junction with Gregory Street.

EXEMPTIONS

The following exemptions apply to the above. Refer to Schedule 1 for the details of each exemption:-

LCCA, LCCB, LCCC, LCCD, LCCF, LCCG, LCCH, LCCM, LCCY.

SCHEDULE 5 PART 2

NO LOADING

MONDAY - SATURDAY 7.30 AM – 9.00 AM AND 4.30 PM – 6.00 PM

DERBY ROAD, LOUGHBOROUGH

- (i) The north-east side from its junction with The Rushes in a north-westerly direction to its junction with Barnsdale Close.
- (ii) The north-east side from its junction with Barnsdale Close in a north-westerly direction to its junction with Grange Street.
- (iii) The north-east side from its junction with Grange Street in a north-westerly direction to its junction with Edward Street
- (iv) The north-east side from its junction with Edward Street in a north-westerly direction to its junction with Belton Road.

HIGH STREET, LOUGHBOROUGH

The north-east side from its junction with Pinfold Gate in a north-westerly direction to its junction with Baxter Gate.

LEICESTER ROAD, LOUGHBOROUGH

- (i) The north-east side from its junction with Gregory Street in a north-westerly direction to its junction with Barrow Street.
- (ii) The north-east side from its junction with Barrow Street in a north-westerly direction to its junction with Pinfold Gate.

MARKET PLACE, LOUGHBOROUGH

The north-east side from its junction with Baxter Gate in a north-westerly direction to its junction with Swan Street.

SWAN STREET, LOUGHBOROUGH

The north-east side from its junction with Market Place in a north-westerly direction to its junction with The Rushes.

THE RUSHES, LOUGHBOROUGH

- (i) The north-east side from its junction with Swan Street in a north-westerly direction to its junction with Shakespeare Street.
- (ii) The north-east side from its junction with Shakespeare Street in a north-westerly direction to its junction with Bridge Street.
- (iii) The north-east side from its junction with Bridge Street in a north-westerly direction to its junction with Derby Road.

EXEMPTIONS

The following exemptions apply to the above. Refer to Schedule 1 for the details of each exemption:-

LCCB, LCCC, LCCD, LCCG, LCCM.

SCHEDULE 5 PART 3

NO WAITING AT ANY TIME

BROMHEAD STREET, LOUGHBOROUGH

The south-west side from its junction with Nottingham Road in a south-easterly direction to its junction with Bishop Street.

EXEMPTIONS

The following exemptions apply to the above. Refer to Schedule 1 for the details of each exemption:-

LCCA, LCCB, LCCC, LCCD, LCCE, LCCF, LCCG, LCCH, LCCI, LCCJ, LCCM, LCCN.

NO WAITING AT ANY TIME

DERBY ROAD, LOUGHBOROUGH

- (i) The north-east side from its junction with The Rushes in a north-westerly direction to its junction with Barnsdale Close.
- (ii) The north-east side from its junction with Barnsdale Close in a north-westerly direction to its junction with Grange Street.

(iii) The north-east side from its junction with Grange Street in a north-westerly direction to its junction with Edward Street.

(iv) The north-east side from its junction with Edward Street in a north-westerly direction to its junction with Belton Road.

HIGH STREET, LOUGHBOROUGH

The north-east side from its junction with Pinfold Gate in a north-westerly direction to its junction with Baxter Gate.

LEICESTER ROAD, LOUGHBOROUGH

(i) The north-east side from its junction with Gregory Street in a south-easterly direction for a distance of 2 metres.

(ii) The north-east side from its junction with Gregory Street in a north-westerly direction for a distance of 2 metres.

(iii) The north-east side from the boundary of Nos. 24/26 Leicester Road in a north-westerly direction to its junction with Barrow Street.

(iv) The north-east side from its junction with Barrow Street in a north-westerly direction to its junction with Pinfold Gate.

(v) The north-east side from a point 42 metres north of its junction with Gregory Street in a north-westerly direction for a distance of 13 metres.

(vi) The north-east side from a point 68 metres north of its junction with Gregory Street in a north-westerly direction for a distance of 10 metres.

MARKET PLACE, LOUGHBOROUGH

The north-east side from its junction with Baxter Gate in a north-westerly direction to its junction with Swan Street.

SWAN STREET, LOUGHBOROUGH

The north-east side from its junction with Market Place in a north-westerly direction to its junction with The Rushes.

THE RUSHES, LOUGHBOROUGH

(i) The north-east side from its junction with Swan Street in a north-westerly direction to its junction with Shakespeare Street.

(ii) The north-east side from its junction with Shakespeare Street in a north-westerly direction to its junction with Bridge Street.

(iii) The north-east side from its junction with Bridge Street in a north-westerly direction to its junction with Derby Road.

EXEMPTIONS

The following exemptions apply to the above. Refer to Schedule 1 for the details of each exemption:-

LCCB, LCCC, LCCD, LCCG, LCCM.

SCHEDULE 5 PART 4

NO WAITING

MONDAY - SATURDAY 7.30 AM – 9.00 AM AND 4.30 PM – 6.00 PM

LEICESTER ROAD, LOUGHBOROUGH

(i) The north-east side from a point 2 metres north-west of its junction with Gregory Street in a north-westerly direction for a distance of 40 metres.

(ii) The north-east side from a point 55 metres north-west of its junction with Gregory Street in a north-westerly direction for a distance of 13 metres.

(iii) The north-east side from a point 78 metres north-west of its junction with Gregory Street in a north-westerly direction to the boundary of Nos. 24/26 Leicester Road.

(iv) The north-east side from a point 10 metres north-west of its junction with Factory Street in a north-westerly direction to a point 2 metres south-east of its junction with Gregory Street.

EXEMPTIONS

The following exemptions apply to the above. Refer to Schedule 1 for the details of each exemption:-

LCCB, LCCC, LCCD, LCCG, LCCM.

29533(a)

THE COMMON SEAL of THE
LEICESTERSHIRE COUNTY COUNCIL
was hereunto affixed this 20th day of
July 2011 in the presence of

)
)
)
)



LOUGHBOROUGH

This drawing is indicative and should be used for illustrative purposes only. This drawings does not form a part of the final legal order.
Any existing restrictions not shown on this drawing do not form a part of the proposals and will therefore remain unchanged.

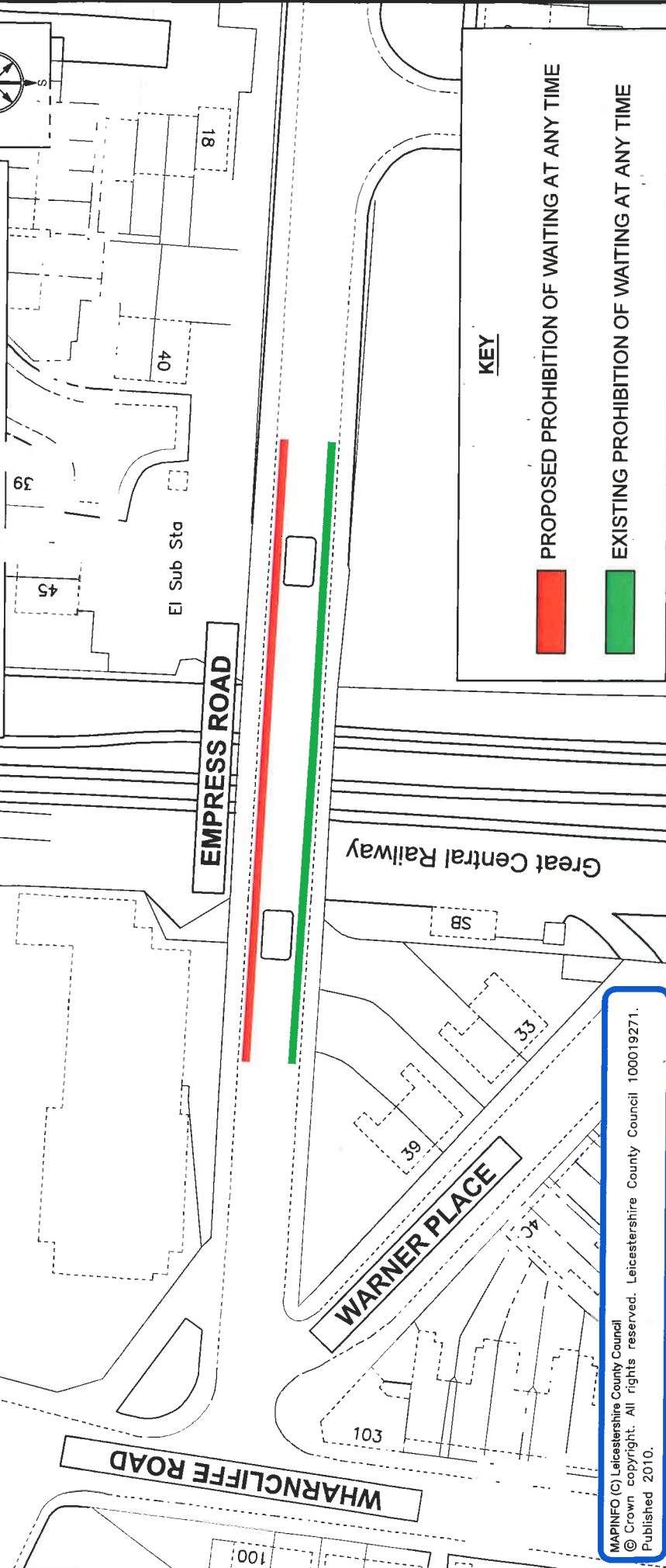

KEY

PROPOSED PROHIBITION OF WAITING AT ANY TIME

EXISTING PROHIBITION OF WAITING AT ANY TIME



ENVIRONMENT AND
TRANSPORT DEPARTMENT

MATTHEW LUGG
DIRECTOR
B.Eng., C.Eng., MICE., MIHT., DMS.

HIGHWAY MANAGEMENT

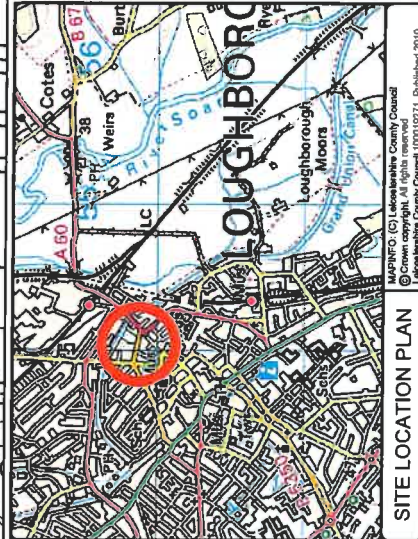

SITE LOCATION PLAN

MAPPING (C) Leicestershire County Council
© Crown copyright. All rights reserved.
Leicestershire County Council 100019271. Published 2010

TITLE:

LOUGHBOROUGH
EMPRESS ROAD

PROPOSED PROHIBITION OF WAITING AT ANY TIME

DRAWING NUMBER
TM3715/1/2010

SCALE
1:750

JOB No.
TM3715

Ref.
MS/MA/5.1.2/TM3715

Prepared By:
MATT ARCHER

AUTOCAD PROJECT DIR:

AUTOCAD FILENAME:

NORTHERN AREA • HAWCLIFFE ROAD • MOUNTSORREL • LE12 7AH

Tel: 0116 305 0001

E-Mail address: customerservices@leics.gov.uk

www.leics.gov.uk

LOUGHBOROUGH

Limehurst
High School

GLADSTONE STREET

TATMARSH

Ivy
Lodge

BRIDGE STREET

Bridge House

RECTORY PLACE

FENNEL STREET



SITE LOCATION PLAN

MAPINFO: (C) Leicestershire County Council
© Crown copyright. All rights reserved.
Leicestershire County Council 100019271, Published 2010.

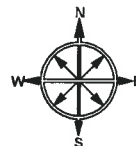

KEY:
**Proposed Prohibition of
Waiting (At any time).**



This drawing is indicative and should be used for illustrative purposes only. This drawing does not form a part of the final legal order.

Any existing restrictions not shown on this drawing are not affected by the proposals and therefore will remain unchanged.

MAPINFO: (C) Leicestershire County Council
© Crown copyright. All rights reserved.
Leicestershire County Council 100019271, Published 2010.



**ENVIRONMENT AND
TRANSPORT DEPARTMENT**

**MATTHEW LUGG
DIRECTOR**
B.Eng., C.Eng., MICE., MCIHT., DMS.

NORTHERN HIGHWAYS

TITLE:

LOUGHBOROUGH - TATMARSH PROPOSED PROHIBITION OF WAITING (AT ANY TIME) ORDER.

DRAWING NUMBER

TM2904/1/2010

SCALE

1:1250

JOB No.

TM 2904

DATE: 23/08/2010

Ref:

MS/SW/5.1.5

SIZE: A4

Prepared By:

S D WELLS

CORR. FILE

AUTOCAD PROJECT DIR: k:\ (OVERTYPE FULL LOCATION HERE)

AUTOCAD FILENAME: (OVERTYPE FILE NAME HERE)

LCC HIGHWAYS, GRANITE WAY, MOUNTSORREL, LE12 7TZ

Tel: 011 305 0001 * Fax * 0116 3052150

E-Mail address:

northerndivision@leics.gov.uk

www.leics.gov.uk